

 **TUBESCA-COMABI**

P R E S E N T S

UNYC[®]

A COMPLETE RANGE OF FALL PROTECTION



UNYC®

YOUR LIFE IS UNIQUE

THE NEW RANGE OF FALL ARRESTER PRODUCTS, DESIGNED FOR THE BUILDING AND PUBLIC WORKS SECTOR AND INDUSTRY.

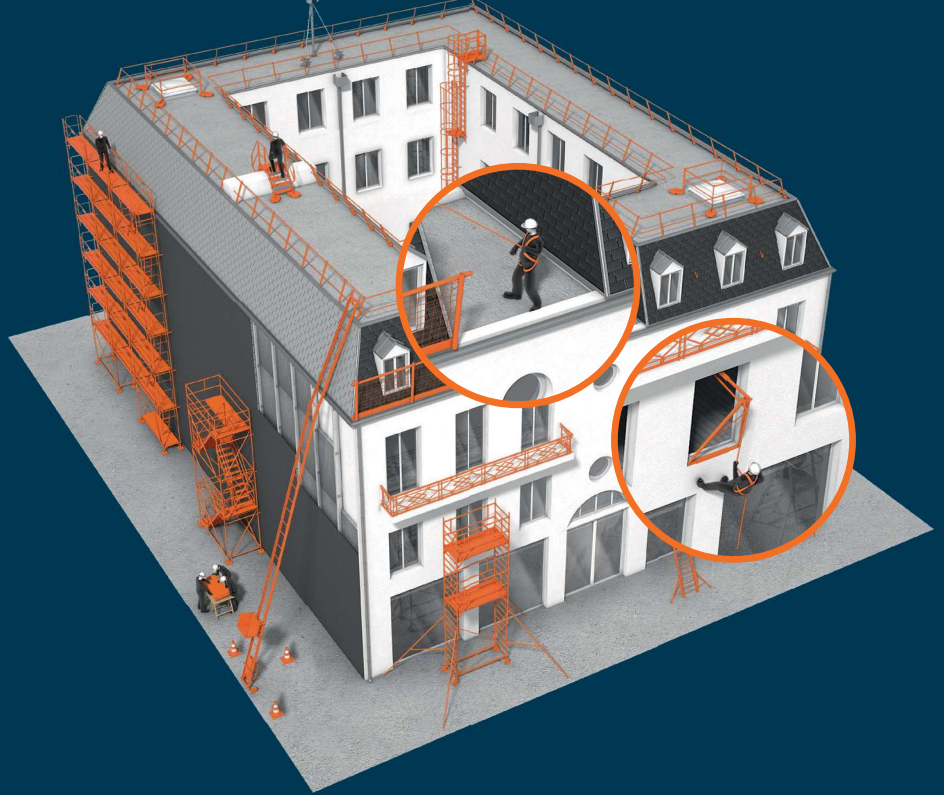

Launching a range of safety harnesses appeared logical as part of our “TRUST AT HEIGHT” vision.

We designed **5 harnesses** to cover all requirements (fall prevention, work positioning and suspension).

To simplify the process of selecting a harness and store sales, **8 ready-to-use kits** are available to meet the needs of all trades (construction, industry, scaffolding firms, waterproofers, joiners, roofers, carpenters, rope access technicians, pylon technicians, tree trimmer, etc.).

ANNUAL INSPECTIONS

All PPE must be **inspected on an annual basis** to ensure conformity with legal requirements and to make sure that all equipment used is in full working order. The inspection report must be recorded in the safety register. If uncertain, immediately withdraw the item from use.

Tubesca-Comabi can organize **PPE inspection sessions** by our safety specialists aiming to monitor products and maintain optimal conditions. Contact your rep. for information or to organise an inspection for your sector.

REGISTERING PPE

A **PPE registration system** is available at www.unyc.com. You will receive your registration certificates, inspection deadline alerts and information on regulations and standards by email.

WHEN IS A HARNESS NECESSARY?

A harness is necessary if **collective protective equipment is technically infeasible**, and the use of Personal Protective Equipment to prevent falls from heights is mandatory.

These personal protective systems are used to arrest falls. PPE can also be used to protect the members of personnel installing collective protective equipment if the operating procedures applied are not compatible with fall prevention.

Such systems will always comprise:

- ▶ **1 safety harness**
- ▶ **1 lanyard or rope**
- ▶ **connectors (carabiners, etc.)**
- ▶ **1 anchor (lifeline, anchor, etc.)**

CE markings are required for the different components.



TYPES OF USE



WORKSITE SAFETY

This system is designed to restrict the user's movements to prevent them from reaching areas where they could fall. This system will not arrest a fall and cannot be used for work positioning or suspension. This system comprises an anchor, a fall arrester harness and a lanyard (adjust to prevent falls).



FALL PREVENTION

This system can arrest a fall and suspend a user until the emergency services arrive. This system comprises an anchor, a fall arrester harness and a fall arrester (lanyard with energy absorber or a rope with a mobile fall arrester block or inertia reel).



WORK POSITIONING

This system allows the user to support themselves with their feet, leaving their hands free for the job. This system comprises an anchor, a fall arrester harness with a work positioning belt and a positioning lanyard. If the user could fall, this system must be completed with a fall arrester (lanyard with energy absorber or a rope with a mobile fall arrester block or inertia reel).



SUSPENSION

This system is designed for work when suspended over empty space thanks to the abdominal attachment point. As the user is no longer supported by their own feet, the load is spread over the harness belt and thigh straps. This system comprises an anchor, a fall arrester harness, a fall arrester (lanyard with energy absorber or a rope with a mobile fall arrester block or inertia reel) and a carabiner/snap.

FALL FACTOR

The fall factor indicates the intensity of a fall. 3 fall risk levels exist (0, 1 and 2). The level is calculated based on the position of the anchor with respect to the user. We strongly recommend that the anchor should be above the user to limit any impact forces.

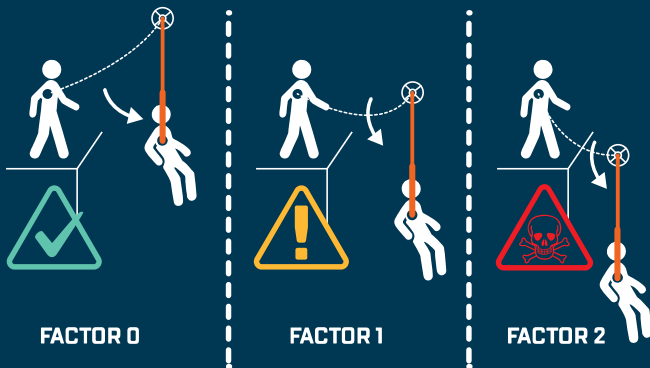

PENDULUM EFFECT

The pendulum effect means that the user could swing sideways if they fall. The user could then hit the floor or an obstacle and be seriously injured. It is important to place the lanyard anchor as far as possible from any obstacle and to prevent any configuration with a risk factor of 2.

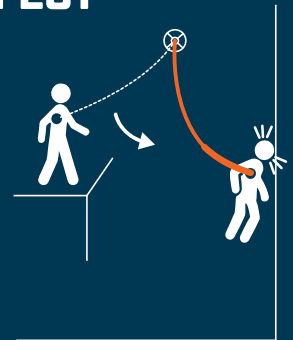

CLEARANCE

The clearance is the distance required between the anchor and the ground-level surface. Clearance depends on the position of the anchor and the selected fall prevention device.

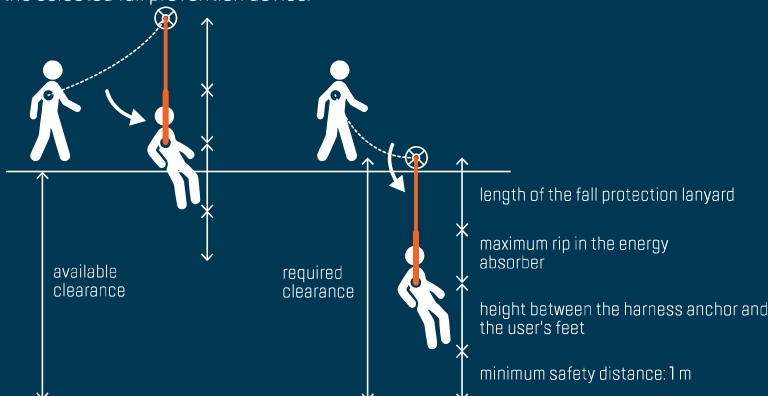

Available clearance is the distance between the structure on which the user is working and the nearest obstacle.
Required clearance is the minimum distance which allows a user to fall with no risk of hitting the floor or the nearest obstacle.

APPLICABLE STANDARDS

- EN 361** Fall arrester harness
- EN 358** Work positioning and safety systems
- EN 813** Belts with thigh straps
- EN 354** Lanyards
- EN 355** Energy absorbers
- EN 1891** Semistatic ropes with low elongation coefficient
- EN 353-2** Mobile fall arresters including a flexible relay device
- EN 360** Retractable type fall arresters
- EN 795** Anchor devices (class A for fixed anchors and class B for mobile anchors)
- EN 362** Connectors
- EN 12492** Climber helmets
- EN 397** Industrial hard hats



OUR RANGE OF FALL-ARRESTER, WORK POSITIONING AND SUSPENSION HARNESSSES

BUDGET

TUBESCA-CDMABI
 Max. load 100 kg
 Suspension EN 361
 Standard EN 358

Price per unit
 5 stars
 CE



ESSENTIAL

TUBESCA-CDMABI
 Max. load 140 kg
 Suspension EN 361
 Standard EN 358

Price per unit
 4 stars
 CE



COMFORT

TUBESCA-CDMABI
 Max. load 140 kg
 Suspension EN 361
 Standard EN 358

Price per unit
 4 stars
 CE

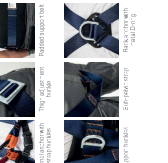

EXPERT

TUBESCA-CDMABI
 Max. load 140 kg
 Suspension EN 361
 Standard EN 358

Price per unit
 5 stars
 CE

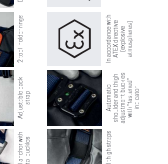

MASTER

TUBESCA-CDMABI
 Max. load 140 kg
 Suspension EN 361
 Standard EN 358

Price per unit
 5 stars
 CE



EQUIPMENT

MOBILE FALL ARRESTER BLOCK

Specialized fall arrester for fall arrest or fall restraint systems.
 Single 2, 3 or 4 mm Ø 10 mm connectors.
 ▶ Compliant with standard EN 358

Max. load 20 kN
 CE



ELASTIC LANYARDS

Single 2, 3 or 4 mm Ø 10 mm connectors.
 ▶ Compliant with standard EN 358

Max. load 20 kN
 CE



SEMI-STATIC ROPES

Semi-static ropes made from 8, 11 mm. Buckles for men.
 ▶ Compliant with standard EN 361

Max. load 20 kN
 CE



RETRACTABLE TYPE FALL ARRESTER STRAP/VERTICAL REEL/ALU HOOK

With built-in energy absorber. 3500 mm. Lock on ceiling and.
 ▶ Compliant with standard EN 361

Max. load 20 kN
 CE



ROPE LANYARDS

Single 2, 3 or 4 mm Ø 10 mm connectors.
 ▶ Compliant with standard EN 358

Max. load 20 kN
 CE



RETRACTABLE TYPE FALL ARRESTER

With built-in energy absorber. 3500 mm. Lock on ceiling and.
 ▶ Compliant with standard EN 361

Max. load 20 kN
 CE

ROPE LANYARDS WITH ENERGY ABSORBER

Single 2, 3 or 4 mm Ø 10 mm connectors.
 ▶ Compliant with standard EN 358

Max. load 20 kN
 CE



ANCHORS

With built-in energy absorber. 3500 mm. Lock on ceiling and.
 ▶ Compliant with standard EN 361

Max. load 20 kN
 CE



WORK POSITIONING ROPE LANYARD

Single 2, 3 or 4 mm Ø 10 mm connectors.
 ▶ Compliant with standard EN 358

Max. load 20 kN
 CE

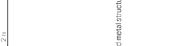

READY-TO-USE KITS

Kit	Max. load	Standard
BUDGET	100 kg	EN 361
ESSENTIAL	140 kg	EN 361
COMFORT	140 kg	EN 361
EXPERT	140 kg	EN 361
MASTER	140 kg	EN 361

BUDGET KIT



BUDGET KIT



ESSENTIAL KIT



ESSENTIAL KIT



COMFORT KIT



EXPERT KIT



MASTER KIT



REFERENCES

Kit	Max. load	Standard
BUDGET	100 kg	EN 361
ESSENTIAL	140 kg	EN 361
COMFORT	140 kg	EN 361
EXPERT	140 kg	EN 361
MASTER	140 kg	EN 361

**QUESTION?
NEED A QUOTE?**

CONTACT OUR SALES TEAM

Tel.: +33 (0) 4 74 00 90 90

Fax: +33 (0) 1 48 46 68 42

sales@tubesca-comabi.com

More information about our harnesses range at:

WWW.TUBESCA-COMABI.INTERNATIONAL/EN

